

ITEM NO	PART NUMBER	DESCRIPTION	SPECIFICATION	MFG
1	13996A10	RPI COVER VESA-B	-	QSINE
2	92005A220	PAN HEAD SCREW M4X0.7 - 10 L	PLATED STEEL	MCMMASTER

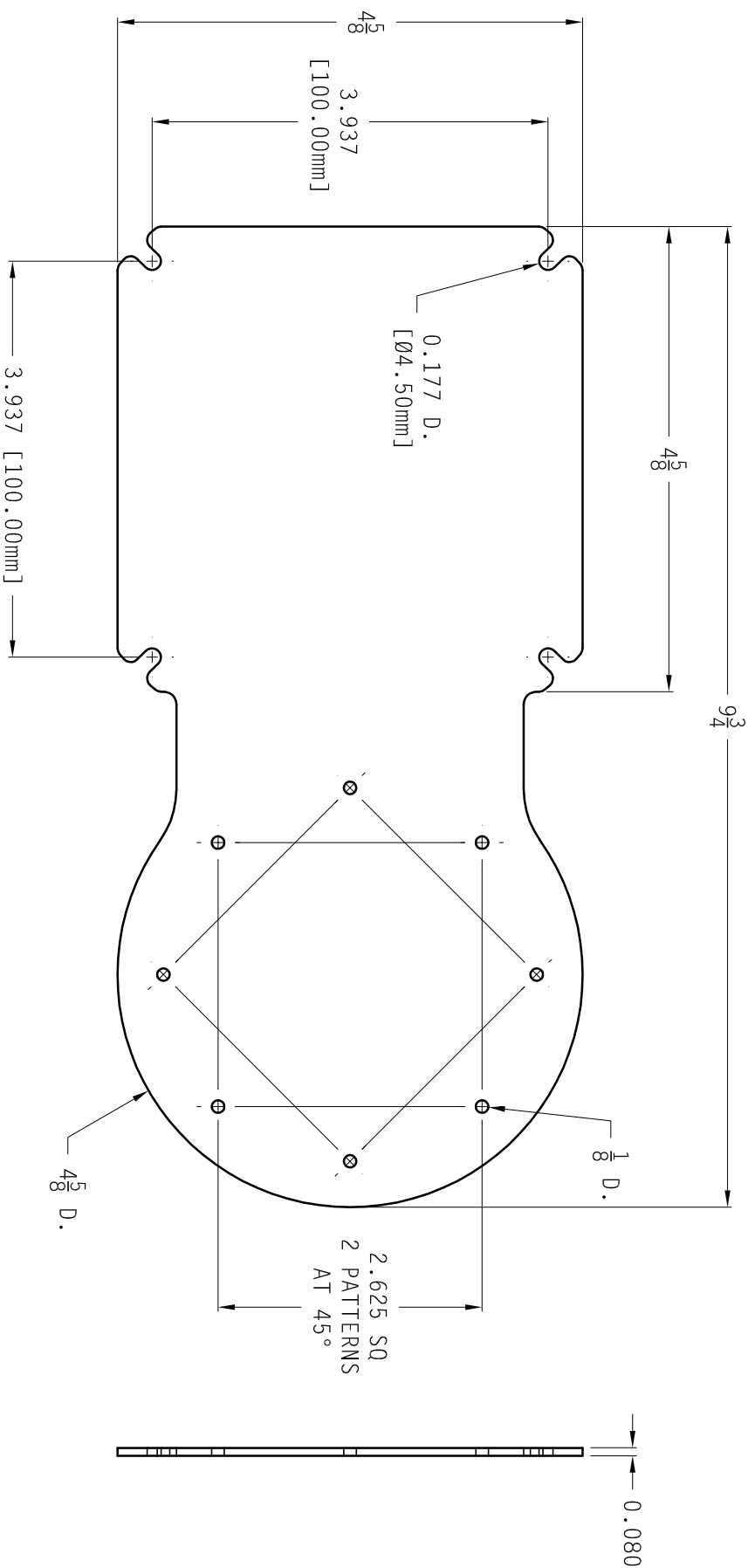

WEIGHT (LBS)	MATERIAL	HEAT TREATMENT	FINISH	NO	BY	DATE	REVISION
~	11494D10-3	BLACK					QSINE
UNLESS NOTED OTHERWISE ALL TOLERANCES AS FOLLOWS							
DECIMALS: 0 ± .060							
FRACTIONS ±1/32							
WELDMENTS & CASTINGS ± 1/16							
ANGULAR ±1°							
REMOVE ALL SHARP CORNERS AND BURRS							
NOTE: THE INFORMATION CONTAINED ON THIS DOCUMENT IS NOT TO BE REPRODUCED OR DISCLOSED WITHOUT THE WRITTEN PERMISSION OF QSINE CORPORATION LIMITED. ALL RIGHTS TO THE INFORMATION CONTAINED ON THIS DOCUMENT ARE RESERVED BY QSINE CORPORATION LIMITED							
DRN		SCALE		DWG NO		SHEET	
KS 280CT13		~		13996A10		1 OF 1	
MDG				CALGARY CANADA			
CHK				QSINE			